

PL. NO. - 10.22.0173 CAT. No. - 2153175 DRP. No. - 13111H/3

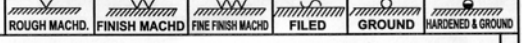

NOTE:-
 1. ALL DIMENSIONS ARE IN 'mm' EXCEPT OTHERWISE SHOWN.
 2. THREADS SHOULD CONFORM TO BS.1580.
 3. WASHER FACE TO BE SQUARE WITH THREADS WITHIN 0.127.

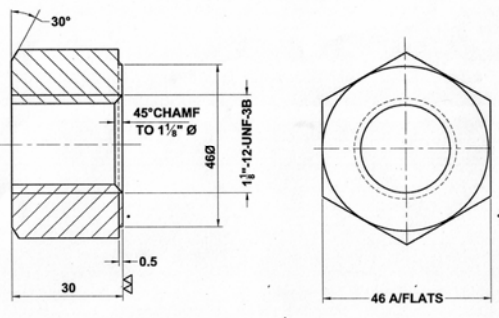

ALL OVER EX-HEX

SSE / ID	CHD	TRD	DRN	COPIED	MATERIAL	STEEL CL4	1	DA-1073 AS-1818	STEEL CL.4 IS.1875 WAS C.R. STEEL,81345	29.8.75	WHERE USED	WDM - 2
					SPEC. No.	I.S.1875	ALT.	AUTH.	DESCRIPTION	DATE	FOR LOCOS	No. OFF
					TREAT.	-					CONTROLLED BY	
					WEIGHT	-						for Sr. DME (D) ET
					SCALE	NTS						CENTRAL RAILWAY DRG. No.
					REF. DRG.	15D 72107-1						CI/EN-702 ALT.1
NUT CYL-HEAD STUD												
MECHANICAL DEPARTMENT, WEST CENTRAL RAILWAY, JABALPUR												

PL. NO. -10-22-0252 CAT. No. - 2155891 (25) DRP. No. - 14519

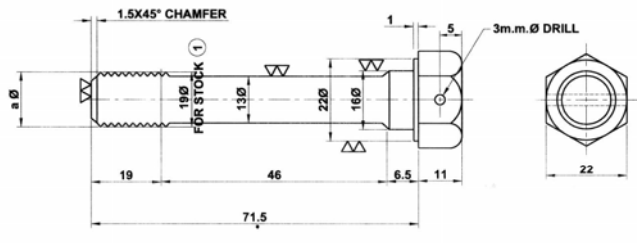
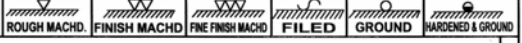

C.R. PART NO.	THREADS
CI/MISC-41	SEE NOTE
CI/MISC-42	5/8" Ø X 11 T.P.I. ANC. M - 16

NOTES:-
 1. INDENTOR SHOULD SPECIFY THE REQUIRED THREADS WHEN ORDERING.
 2. FOR RAILWAY WORKS MATERIAL TO BE STOCKED TO CHAIN DOTTED LINES & MACHINED TO SUIT PART NO. AS REQUIRED.
 3. THIS THREAD SHOULD CONFORM TO BS:1580.

SSE / ID	CHD	TRD	DRN	COPIED	MATERIAL	STAINLESS STEEL.	2	DA-4242 AS-723	CI - WAS D.	5-6-69	WHERE USED	WDM-2
					SPEC. No.	DLW.NO. 90161	ALT.	AUTH.	DESCRIPTION	DATE	FOR LOCOS	No. OFF
					TREAT.	-			STOCK SIZE ADDED.	31-1-64	CONTROLLED BY	
					WEIGHT	-						for Sr. DME (D) ET
					SCALE	N.T.S.						CENTRAL RAILWAY DRG. No.
					REF. DRG.	-						CI/MISC - 41 ALT.2 CI/MISC - 42
BOLT SPECIAL (FOR TURBO NOZZLE RING)												
MECHANICAL DEPARTMENT WEST CENTRAL RAILWAY , JABALPUR												

PL. NO.- 10.22.0460		CAT. No.- 2261154	DRP. No.- 14519-26	ROUGH MACHD.	FINISH MACHD.	FINE FINISH MACHD.	FILED	GROUND	HARDENED & GROUND	
<p style="text-align: center;">MANUFACTURER'S IDENTIFICATION MARK TO BE STAMPED HERE.</p>				<p>NOTE:-</p> <ol style="list-style-type: none"> 1. THREADS SHOULD CONFORM TO BS:1580/ASMEB1.1. 2. DIMENSION NOT MENTIONED IN THIS DRAWING SHOULD CONFORM TO BS:1768. 3. CAP SCREW HEAD TO BE COLD FORGED AND THREADS ROLLED. 4. MATERIAL SPECIFICATION & PROPERTY CLASS: IS:1367(P.T.III) Gr:8.8/BS:1768 Gr:"S"/SAE Gr:5. 5. CAP SCREW SHOULD BE LUBRITED,PHOSPHATED OR IN BLACK THERMAL FINISH. <p>PACKING CONDITIONS:- SUITABLE NO. TO BE PACKED IN POLYTHENE BAG, THEN FINALLY TO BE PACKED IN CORRUGATED CARD BOARD BOX</p>						
				WHERE USED		WDM - 2				
				FOR LOCOS		No. OFF				
				CONTROLLED BY						
				for Sr. DME (D) ET		CENTRAL RAILWAY DRG. No.				
				<p style="text-align: center;">CAP SCREW FOR INLET TO TURBINE CASING, TURBOCHARGER.</p>		<p style="text-align: center;">CI/MISC-373 ALT. 2</p>				
				MECHANICAL DEPARTMENT, WEST CENTRAL RAILWAY, JABALPUR						
SSE / D	CHD	TRD	DRN	COPIED	MATERIAL	SEE NOTE 4.	2	DA:4453 AS:2548	NOTES 4 & 5 ADDED, NOTES 3 AND PC:CORRECTED.	30.06.95
					SPEC. No.	SEE NOTE 4.	1	DA:2705 AS:2256	DRG. REVISED & RETRACED	19.10.84
					TREAT.			AUTH.	DESCRIPTION	DATE
					WEIGHT					
					SCALE	NTS				
					REF. DRG.	2P10026/048				

PL. NO. -11-98-5859		CAT. No. -	DRP. No. -	ROUGH MACHD.	FINISH MACHD.	FINE FINISH MACHD.	FILED	GROUND	HARDENED & GROUND	
				<p>NOTE:-</p> <ol style="list-style-type: none"> 1. SURFACE MARK ∇ THIS MUST BE FLAT WITHIN 0.254m.m. 2. ALL SHARP EDGES TO BE DEBURRED AND WELL DRESSED. 3. MAKER'S NAME BY ELECTRO ETCHING ON END SURFACE. 4. MATERIAL & SPEC:- 11%-14% MANGANESE STEEL TO IRS. R-65-1978. <p>PACKING CONDITION:- EACH PIECE TO BE OILED THOROUGHLY & EVENLY ON ALL SIDES TO AVOID RUSTING AT LEAST FOR A PERIOD OF 6 MONTHS. MIN. 6 PIECES TO BE PACKED IN HESSIAN CLOTH & STITCHED. FINAL PACKING SHOULD BE DONE IN WOODEN BOXES WITH SUITABLE PACKING MATERIAL & SEALED WITH STRAP TO AVOID DAMAGE DURING TRANSPORT & HANDLING.</p>						
				WHERE USED		WDM-2,WDS-6		48		
				FOR LOCOS		No. OFF				
				CONTROLLED BY						
				for Sr. DME (D) ET		CENTRAL RAILWAY DRG. No.				
				<p style="text-align: center;">HORN & AXLE BOX SIDE LINER (NEI)</p>		<p style="text-align: center;">CI/WA-130 ALT.3</p>				
				MECHANICAL DEPARTMENT WEST CENTRAL RAILWAY, JABALPUR						
SSE / D	CHD	TRD	DRN	COPIED	MATERIAL		3	DA:4466 AS:2550	DRG. REVISED & RE-TRACED	11-9-95
					SPEC. No.		ALT.	AUTH.	DESCRIPTION	DATE
					TREAT.					
					WEIGHT					
					SCALE	N.T.S.				
					REF. DRG.	PL.NO.11454647 (TPL-2367)				



QTY.	PER LOT	REMARKS	PART NO.	REV.	DATE	BY	CHKD.	QTY. PER LOT			REMARKS
								REQD.	ISSD.	IN STK.	
1	01/20/84		012084-055		1/4	28	3/16	28	0	0	
4	01/20/84		012084-055		1/4	28	3/16	28	0	0	
4	01/20/84		012084-055		1/4	28	3/16	28	0	0	
4	01/20/84		012084-055		1/4	28	3/16	28	0	0	
4	01/20/84		012084-055		1/4	28	3/16	28	0	0	
4	01/20/84		012084-055		1/4	28	3/16	28	0	0	
4	01/20/84		012084-055		1/4	28	3/16	28	0	0	
4	01/20/84		012084-055		1/4	28	3/16	28	0	0	
4	01/20/84		012084-055		1/4	28	3/16	28	0	0	

QTY.	PER LOT	REMARKS	PART NO.	REV.	DATE	BY	CHKD.	QTY. PER LOT			REMARKS
								REQD.	ISSD.	IN STK.	
44	01/20/84		012084-056		1/2	13	3/16	13	0	0	
45	01/20/84		012084-056		1/2	13	3/16	13	0	0	
44	01/20/84		012084-056		1/2	13	3/16	13	0	0	
47	01/20/84		012084-056		1/2	13	3/16	13	0	0	
48	01/20/84		012084-056		1/2	13	3/16	13	0	0	
49	01/20/84		012084-056		1/2	13	3/16	13	0	0	
50	01/20/84		012084-056		1/2	13	3/16	13	0	0	
51	01/20/84		012084-056		1/2	13	3/16	13	0	0	
52	01/20/84		012084-056		1/2	13	3/16	13	0	0	

- NOTE-
- 1. MATERIAL SPECIFICATION AND PROPERTY CLASS-
 - (a) 15-1367 OPTID CLASS 8.8/BS1768 GRADE S7/SAE Gr. 5 UP TO 3/4" DIA.
 - (b) 15-1367 OPTID CLASS 10.9/BS1768 GRADE V7/SAE Gr. 8 FROM DIA ABOVE 3/4"
 - 2. THREADS- ROLLED, UNC-2A SERIES, AS PER BS1800 OR ANSI/ASME B1.1 EXCEPT ITEM NO. 75.
 - 3. CAP SCREWS SHOULD BE PHOSPHATED OR IN BLACK THERMAL FINISH.
 - 4. HEAD OF THE CAP SCREW SHOULD BE Cold FORGED.
 - 5. ALL OTHER PARAMETERS CONFORMING TO BS 1768 OR ANSI/ ASME B 18.2.1.
 - 6. INSPECTION SHALL BE DONE AS PER MSC-109.

REV.	ALTERATION	DATE	BY
1	BRANDING DELETED & 10TH REV. NOTED	01/20/84	
2	NOTE NO. 2 REVISED	01/20/84	
3	NOTE NO. 5 REVISED	01/20/84	
4	NOTE NO. 16 & 5 CORRECTED	01/20/84	
5	NOTE NO. 16 & 5 CORRECTED	01/20/84	
6	BRANDING DELETED FROM NOTE NO. 5	01/20/84	
7	PART NO. 15-1367-WAS 15-1367 (CORRECTED)	01/20/84	
8	REV. 2 WAS IN ERROR LINE NO. 4	01/20/84	

ISSUING AUTHORITY - SSC/RC20303
 PART NO. - 15-1367

NOT DRAWN TO A PROPERTY OF DIMENSIONS SHOWN AND NOT UNLESS SPECIFIED BY THE DRAWING WILL BE CONSIDERED LOCAL, THE DIMENSIONS SHOWN WILL HAVE PRIORITY OVER DIMENSIONS SHOWN BY DIMENSIONS.

HEX HEAD CAPSCREW

DIESEL LOCOMOTIVE WORKS

PART NO.-SEE TABLE
 DRG. NO. 15-1367-1-1-001/44
 AUTO. 245